

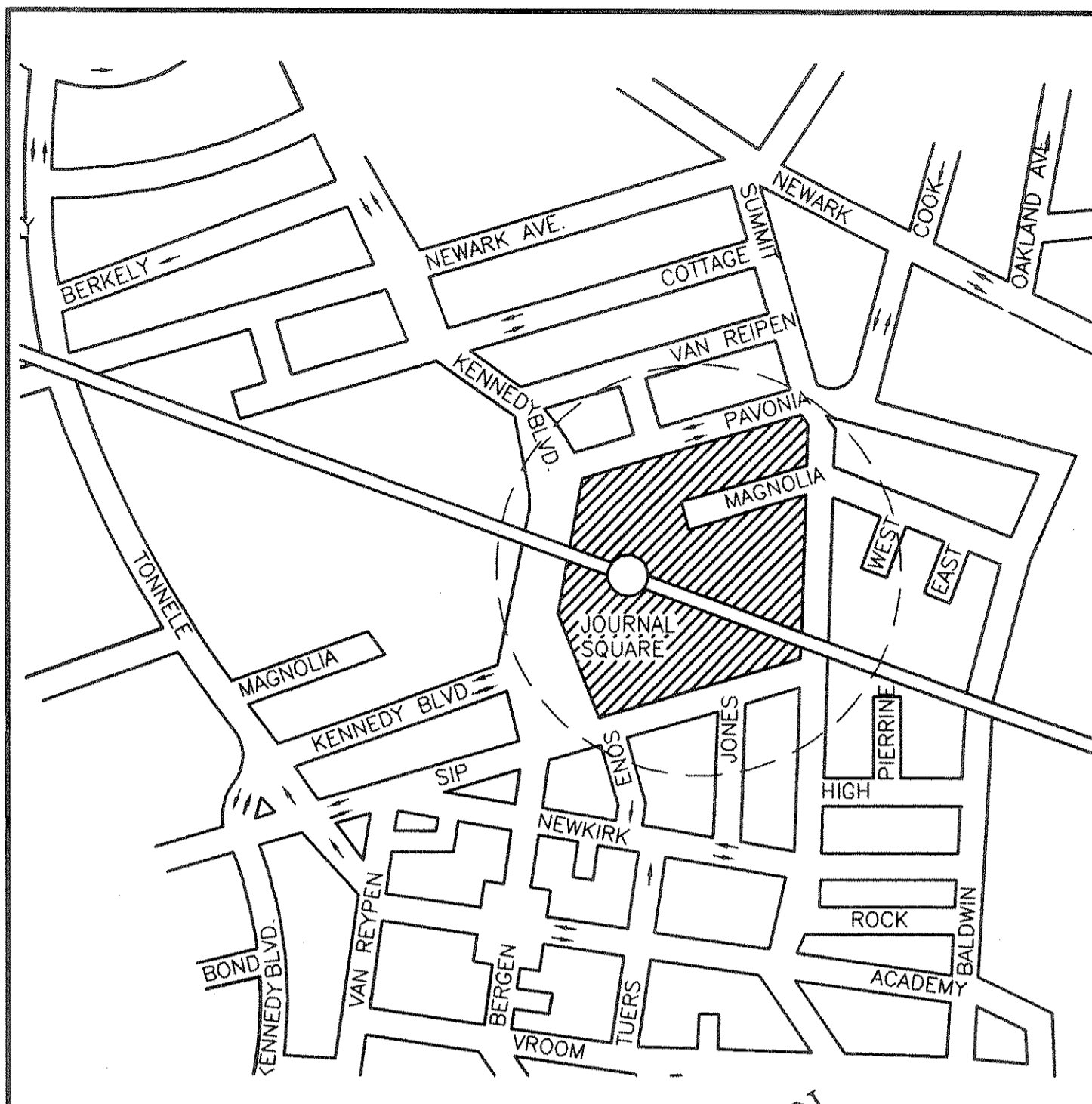

GANNETT FLEMING, P.C.
ENGINEERS AND ARCHITECTS

John D. Purdy
JOHN D. PURDY
N.J. Professional Engineer # 246603967100



P 1 JERSEY CITY VICINITY MAP
G002 NOT TO SCALE

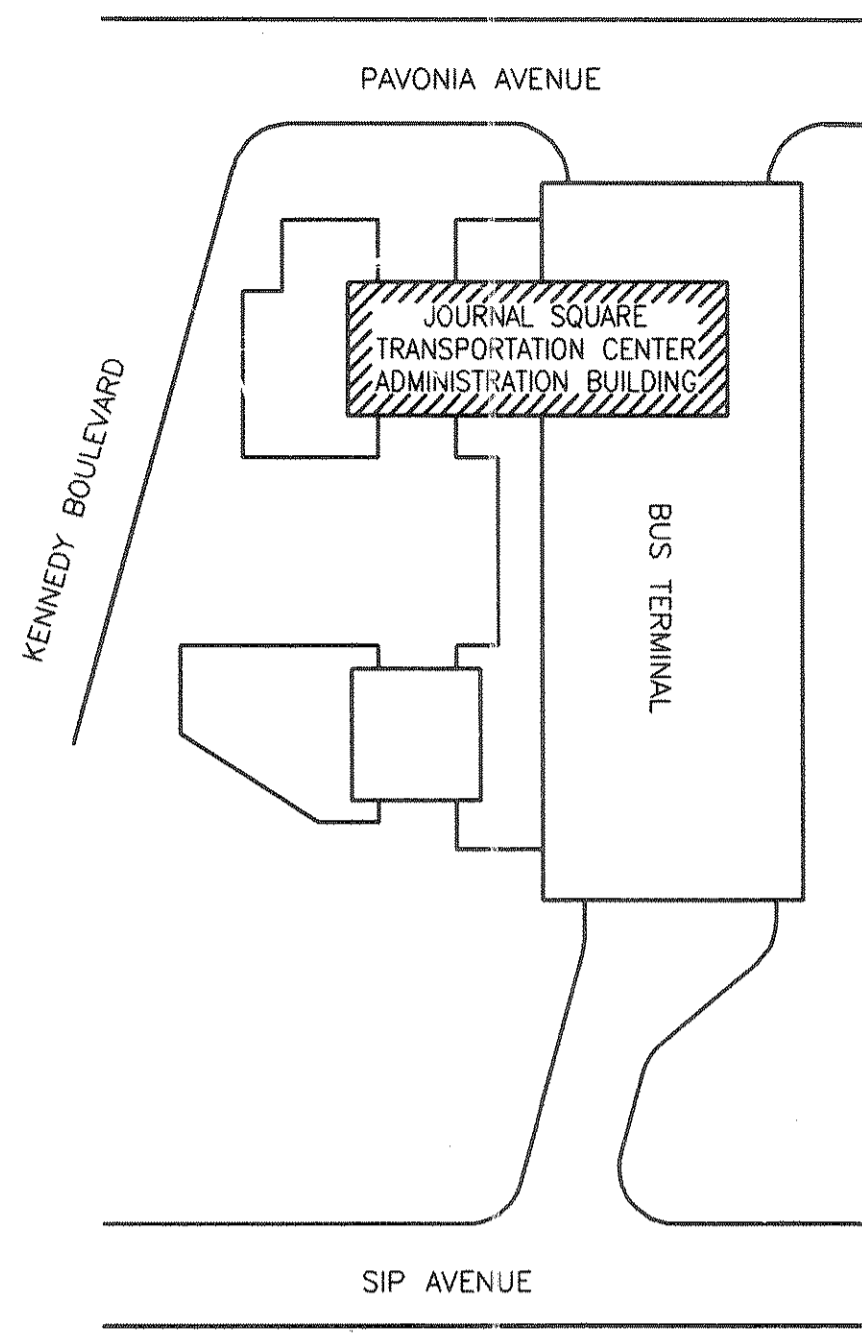

P 2 LOCATION PLAN
G002 NOT TO SCALE

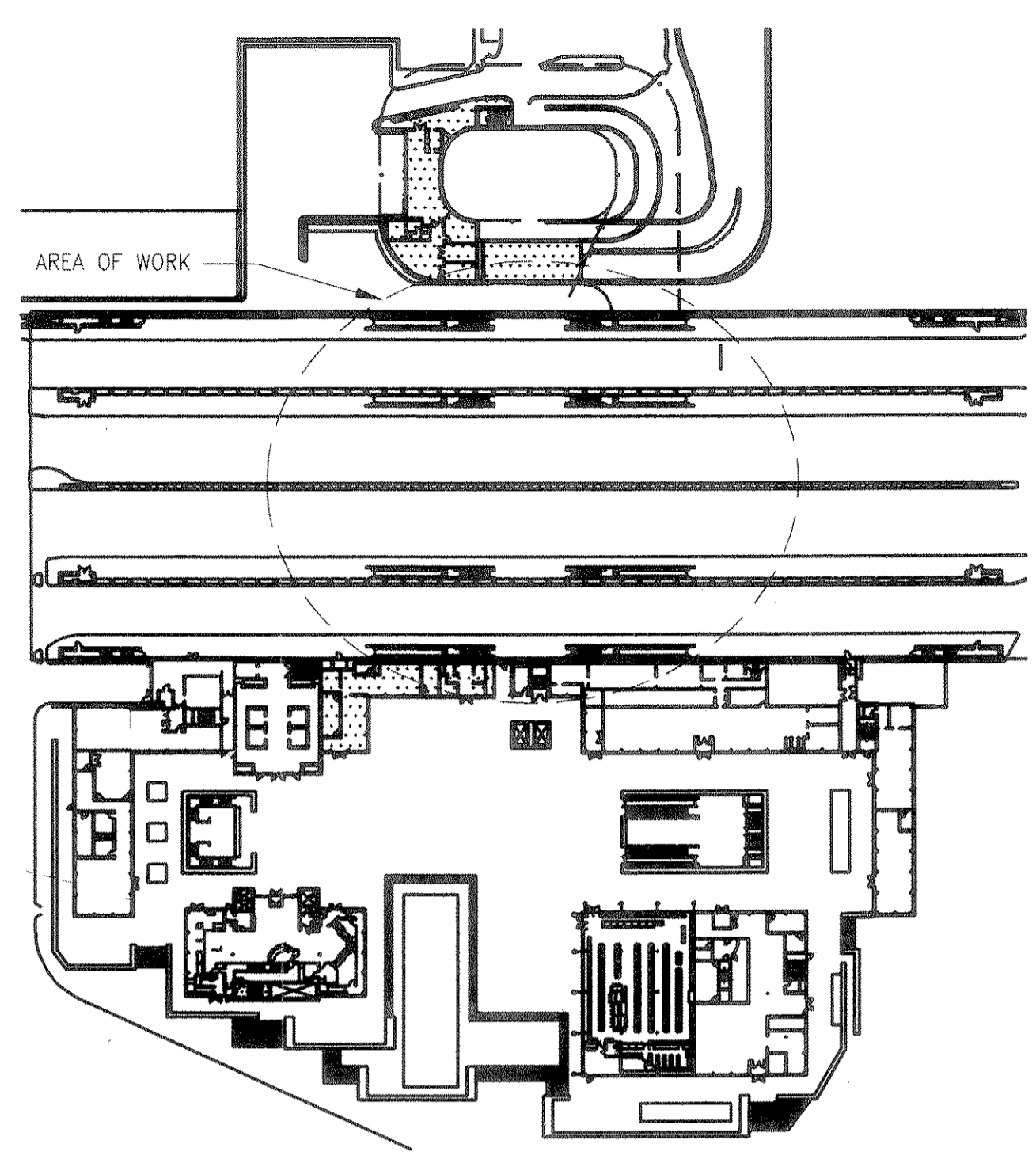

P 3 SITE PLAN
BUS TERMINAL LEVEL N
G002 NOT TO SCALE

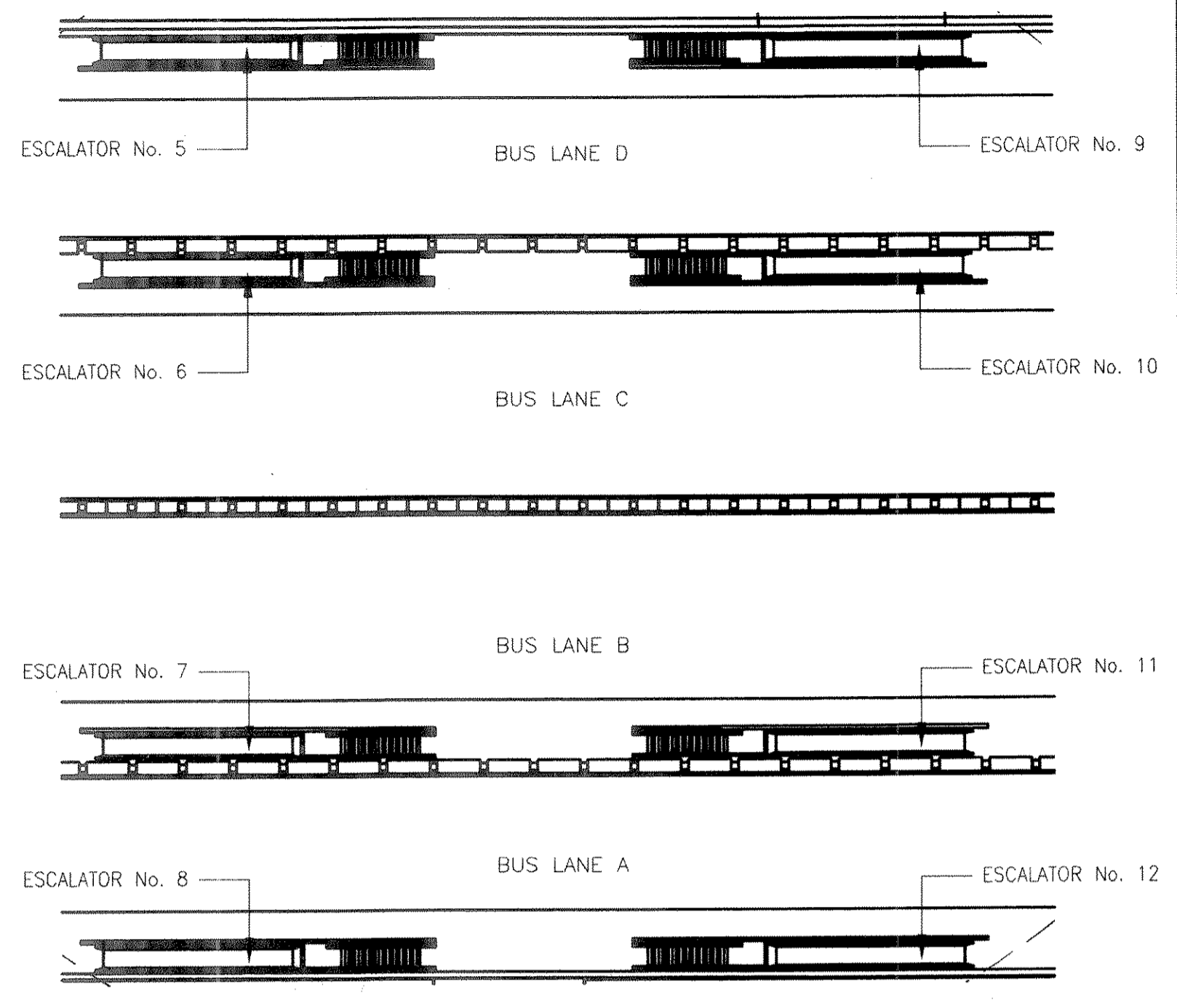

P 6 ENLARGED AREA OF WORK PLAN
BUS TERMINAL LEVEL
G002 NOT TO SCALE

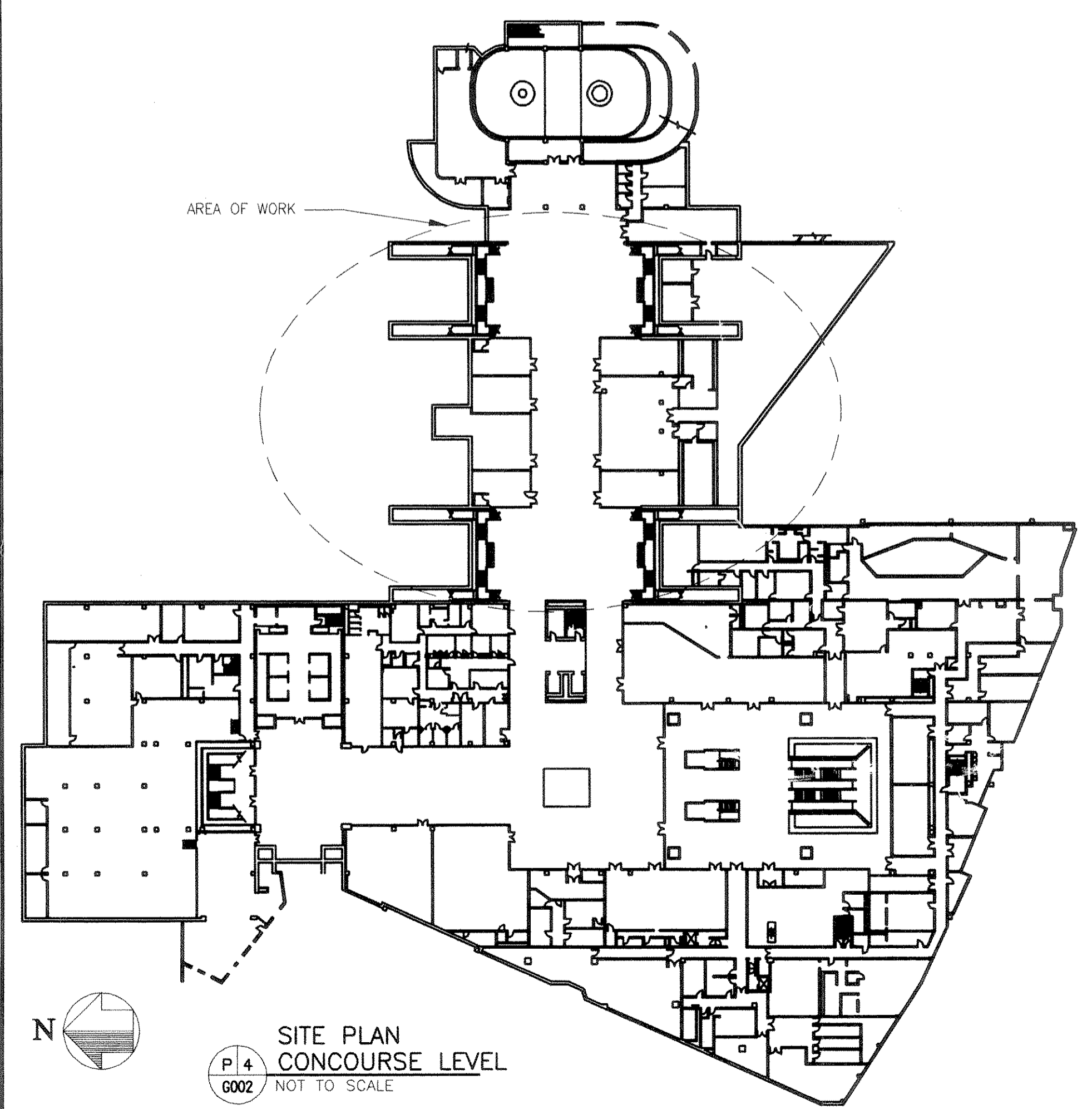

P 4 SITE PLAN
CONCOURSE LEVEL
G002 NOT TO SCALE

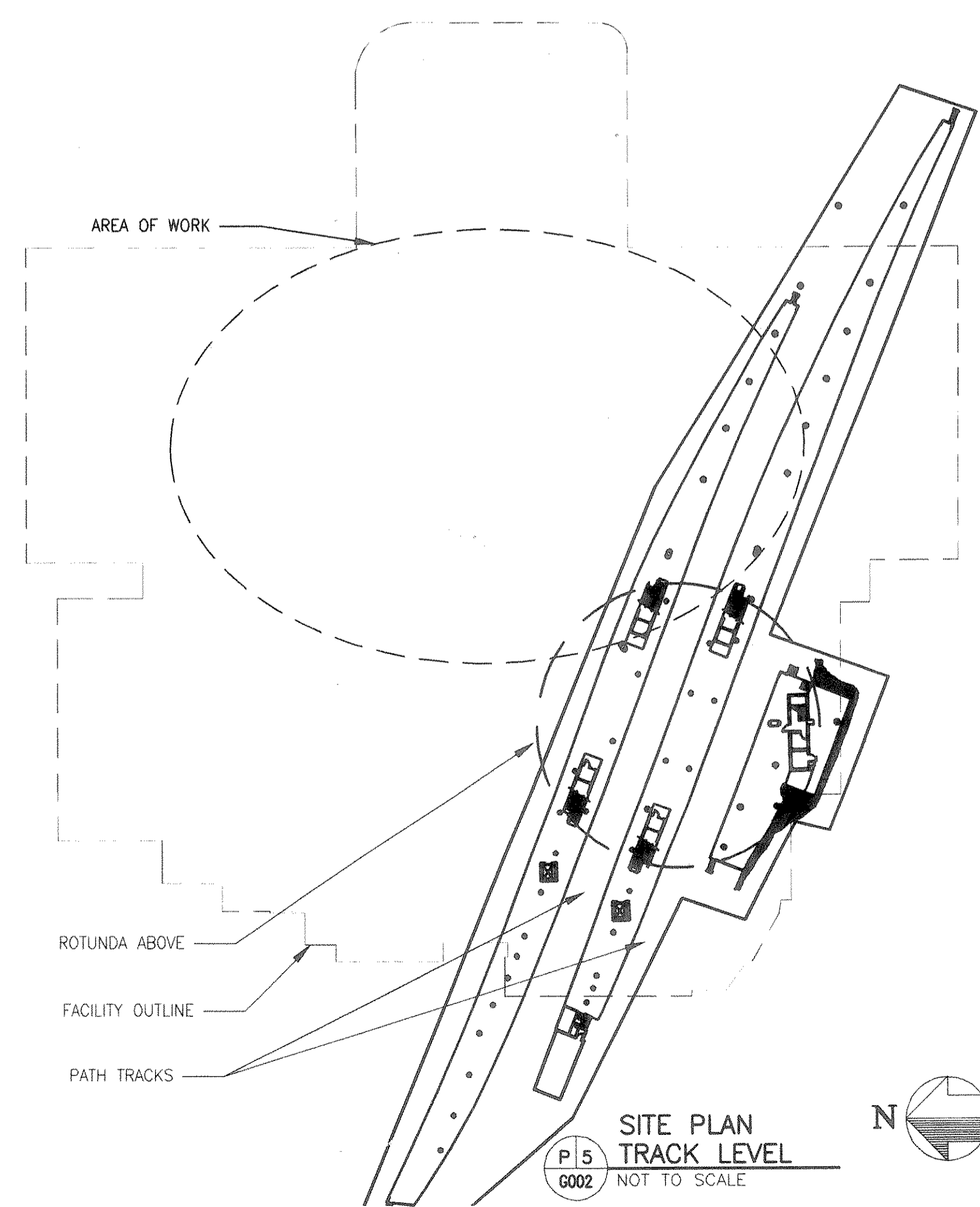

P 5 SITE PLAN
TRACK LEVEL
G002 NOT TO SCALE

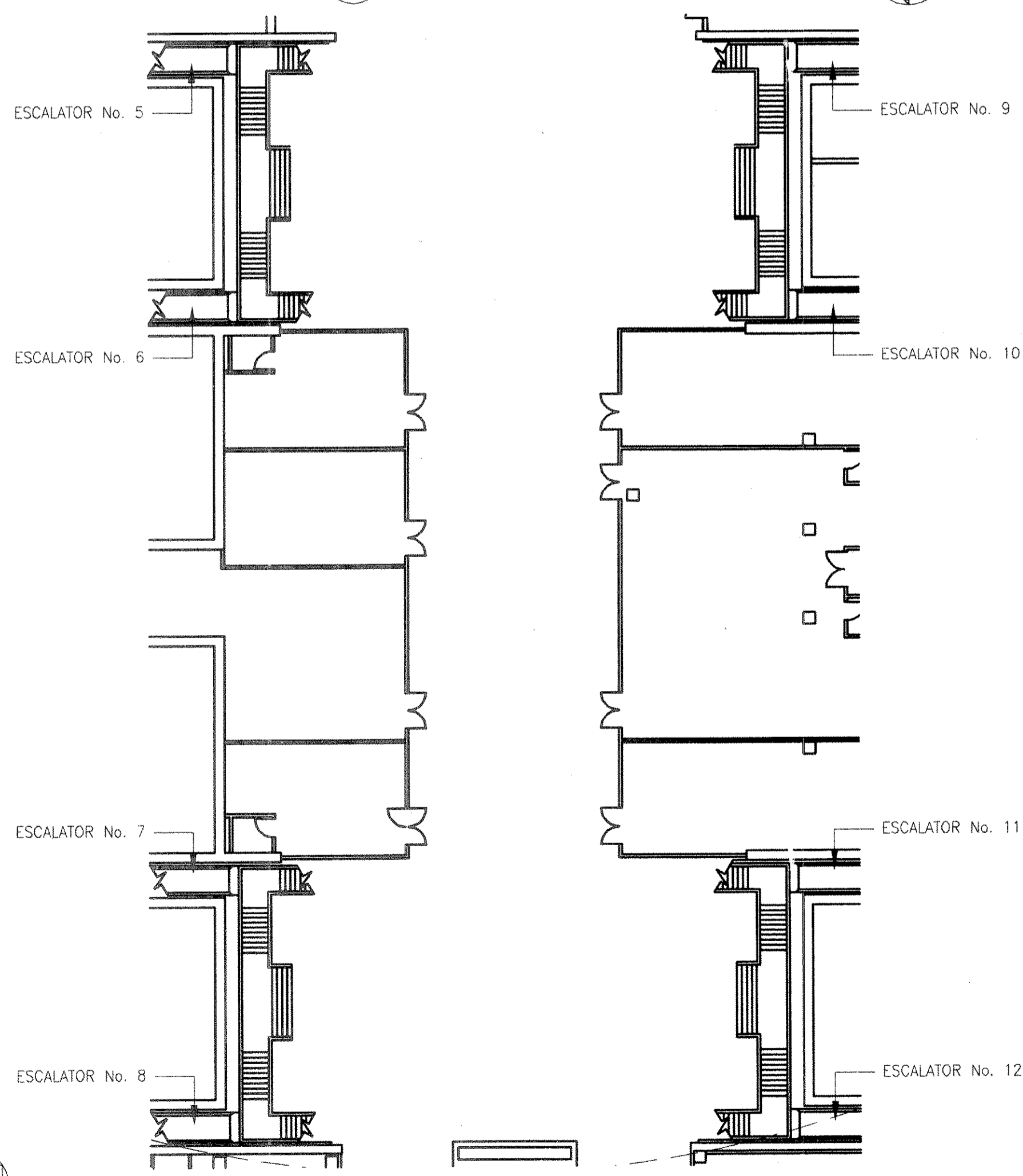

P 7 ENLARGED AREA OF WORK PLAN
CONCOURSE LEVEL
G002 NOT TO SCALE

No.	Date	Revision	Approved
ENGINEERING DEPARTMENT			
JOURNAL SQUARE TRANSPORTATION CENTER			

GENERAL
Title
BUS TERMINAL ESCALATOR REPLACEMENT
LOCATION PLAN, SITE PLAN AND AREA OF WORK PLAN ESCALATOR No. 5 THRU 12

This drawing subject to conditions in contract. All inventions, ideas, designs and methods herein are reserved to Port Authority and may not be used without its written consent.
All recipients of Contract documents, including bidders and those who do not bid and their prospective subcontractors and suppliers who may receive all or a part of the Contract documents or copies thereof, shall make every effort to ensure the secure and appropriate disposal of the Contract documents to prevent further disclosure of the information contained in the documents. Secure and appropriate disposal includes methods of document destruction such as shredding or arrangements with refuse handlers that ensure that third persons will not have access to the documents' contents either before, during, or after disposal. Documents may also be returned for disposal purposes to the Contract file on the 3rd Floor, 3 Gateway Center, Newark, NJ 07102 or the office of the Director of Procurement, One Madison Avenue, 7th Floor, New York, NY 10010.

S. STEINER S. STEINER S. FITZGERALD
Designed by Drawn by Checked by
Date: 11/17/2008

Contract Number: **PAT-214.004**
Drawing Number: **G002**
PID# 07957000