

5

4

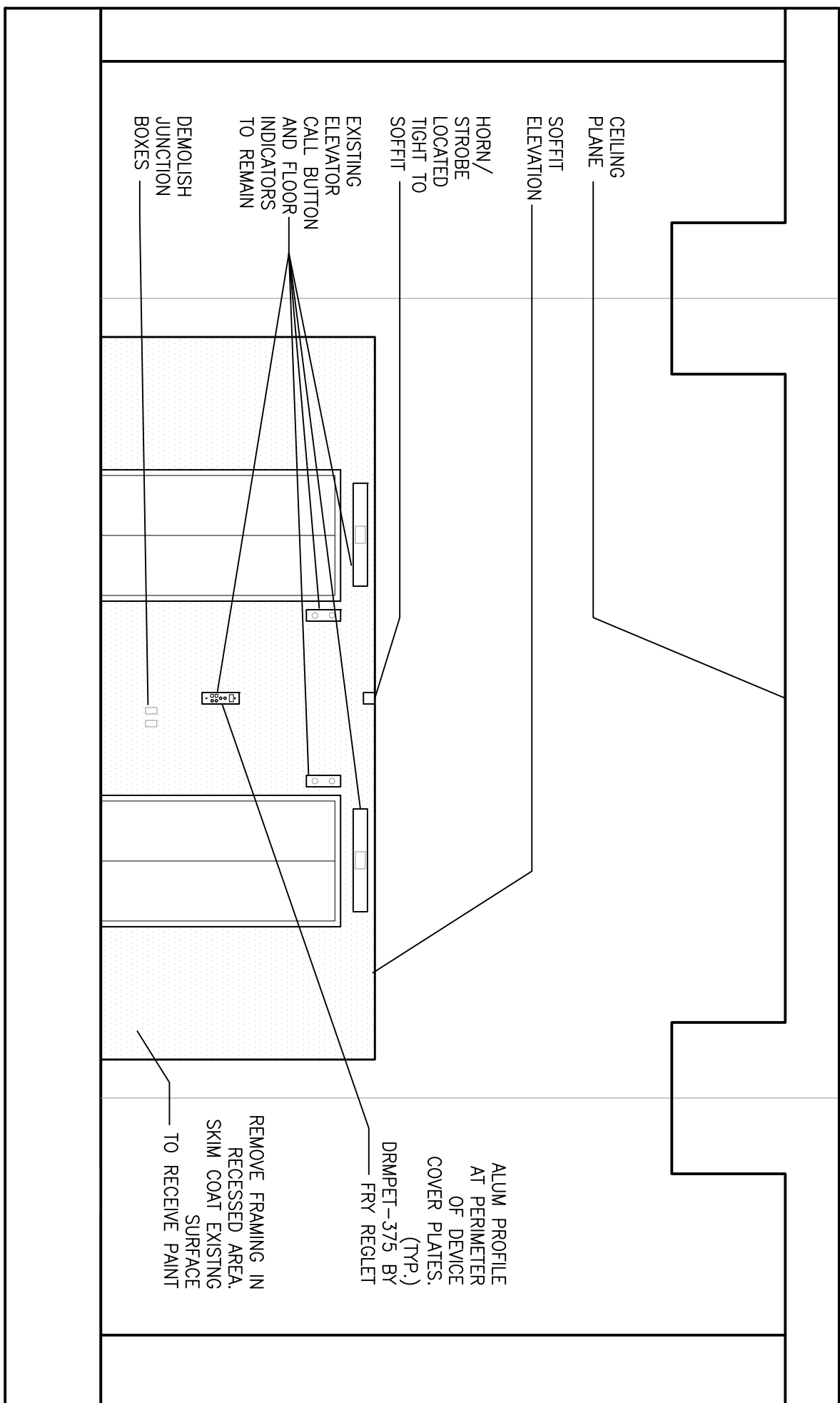

ELEVATOR CORE ELEVATION  
 REF DET: 1/A207

TWG REF DWG: 108813\_elevBaselinew.dwg  
 UNION COUNTY COLLEGE  
 LESSNER FIRST FLOOR ADDITION &  
 FIRST FLOOR & LOWER LEVEL  
 REHABILITATION  
 12 WEST JERSEY STREET  
 ELIZABETH, NJ 07222

REMOVE FRAMING IN  
 RECESSED AREA.  
 SKIM COAT EXISTING  
 SURFACE  
 TO RECEIVE PAINT

ALUM PROFILE  
 AT PERIMETER  
 OF DEVICE  
 COVER PLATES.  
 (TYP.)  
 DRMPET-375 BY  
 FRY REGLET

10-4-2017  
 Project # 108813

SCALE: 1/4" = 1'-0"  
**SK-124**

191 Mill Lane Mountfield, NJ 07092 P: 908.232.2880 F: 908.232.2945

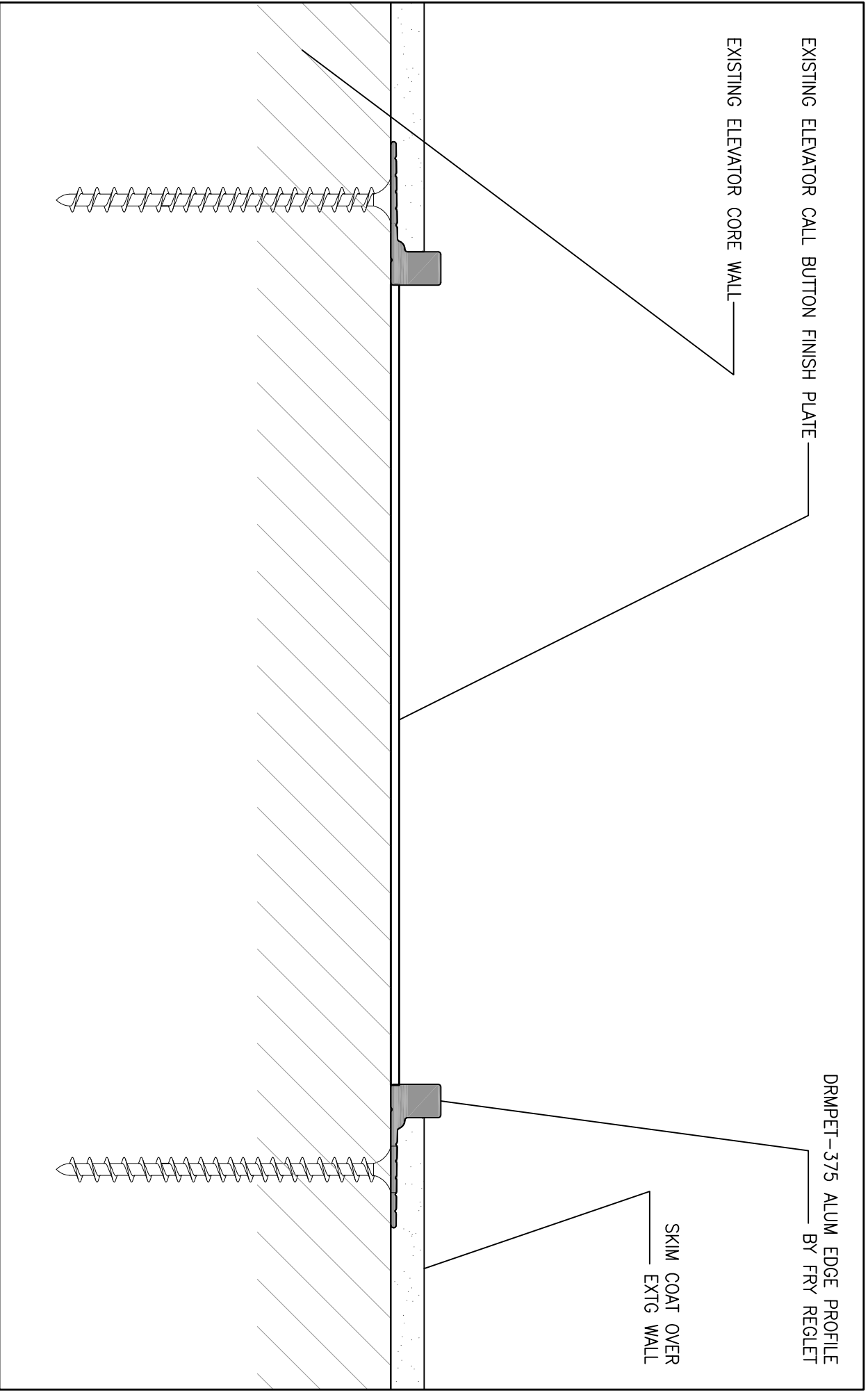

EXISTING ELEVATOR CALL BUTTON FINISH PLATE

EXISTING ELEVATOR CORE WALL

DRMPET-375 ALUM EDGE PROFILE  
BY FRY REGLET

SKIM COAT OVER  
EXTG WALL

EXISTING ELEVATOR DEVICE FINISH DETAIL

TMG REF DWG : 108813\_1-1sfr.dwg  
 12 WEST JERSEY STREET  
 ELIZABETH, NJ 07202  
 UNION COUNTY COLLEGE  
 LESSNER FIRST FLOOR ADDITION &  
 FIRST FLOOR & LOWER LEVEL  
 REHABILITATION

10/4/17  
**SK-124A**  
 Project # 108813  
 FULL SCALE  
 191 Mill Lane Mountaintop, NJ 07092 P. 908.232.2860 F. 908.232.2845

PRODUCT DETAIL

DC.11

PROTRUDING  
EDGE  
PROFILES

**USAGE**  
Fry Reglet Protruding Edge Profiles provide a 1/4" x 1/4" accent feature at reveals, outside corners and transitions at multiple layers of drywall.

**GUIDE SPECIFICATION**

Where indicated on drawings, Fry Reglet Protruding Edge Profiles, as manufactured by Fry Reglet Corporation, shall be installed. Aluminum shall be extruded alloy 6063 T5, with chemical conversion coating, clear anodized or other specified finish. Refer to finish section.

**DRMPET-375**

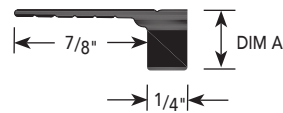

**DRMPET-100**

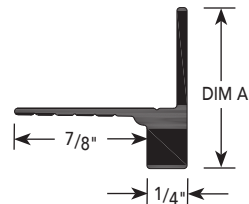

**DRMPWR-100-75**

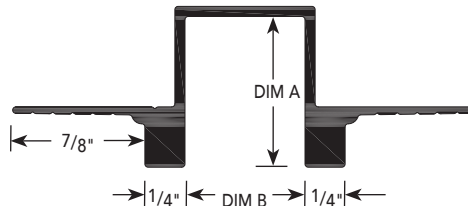

**DRMPCR-100-100**

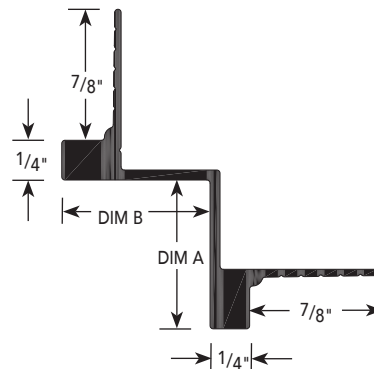

SIZES

DIM. A	DIM. B	NUMBER
3/8"	N/A	DRMPET-375
1"	N/A	DRMPET-100
1"	3/4"	DRMPWR-100-75
1"	1"	DRMPCR-100-100

PROTRUDING  
EDGE  
PROFILES

