

1 HR01 HVAC GROUND FLOOR REMOVALS PLAN
1/8" = 1'-0"

KEYED NOTES

- ① REMOVE UNIT VENTILATOR AND ASSOCIATED LOUVER, DUCTWORK, WALL SENSOR, CONTROL WIRING, AND HOT WATER PIPING.
- ② REMOVE HWS/HWR PIPING, ASSOCIATED SUPPORTS, AND HANGERS.
- ③ REMOVE CONVECTOR AND ALL ASSOCIATED CONTROLS, PIPING, AND SUPPORTS. CAP PIPING AT MAIN.
- ④ REMOVE EXHAUST DUCTWORK AND ASSOCIATED SUPPORTS.
- ⑤ REMOVE SUPPLY DUCTWORK AND ASSOCIATED SUPPORTS.
- ⑥ REMOVE EXISTING STEAM AND CONDENSATE PIPING IN ITS ENTIRETY FOR THE ENTIRE LENGTH OF THE CORRIDOR. REMOVE ALL SUPPORTS AND ACCESSORIES.
- ⑦ CAREFULLY REMOVE EXISTING GAS HEATERS AND TURN OVER TO OWNER. MOVE HEATERS TO STORAGE LOCATION WITHIN DISTRICT AT DIRECTION OF OWNER.

NJ Certificate of Authorization	
Eng'r. No.	24GZP837500
Arch. No.	21AC09012400
Date	01/15/2018
Checked	
Drawn	
KENNETH H. KARLE, R.A. THE REGISTERED ARCHITECT License No. NJ21A0080600	
Revisions:	
LAN ASSOCIATES engineering • planning • architecture • surveying 445 GODWIN AVENUE, MIDLAND PARK, N.J. 07432 (201)447-6400	
HVAC GROUND FLOOR REMOVALS PLAN	ADDITION TO WOODBRIDGE MIDDLE SCHOOL
WOODBRIDGE BOE 525 BARRON AVENUE WOODBRIDGE, NJ 07095	
Job No.	2.20211.07
File No.	
HR01	

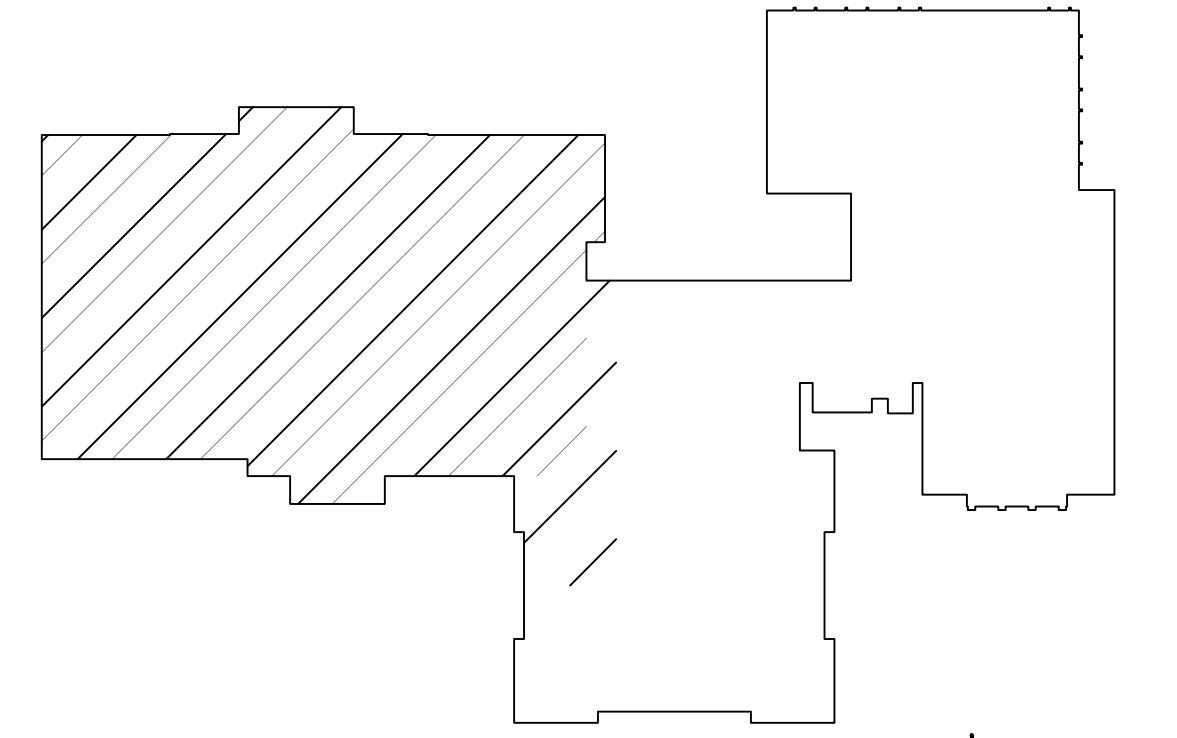

KEY PLAN
N.T.S.

